

## DLS Splined Threaded Insert

Steel · Large flange · Splined · Open end  
M4 - M10

### Features

- Designed to provide load bearing threads in thin sheet materials
- Splined body provides increased torque-to-turn resistance over conventional non-splined inserts
- Reduced tail end diameter offers ease of hole entry
- Large flange head provides a load bearing surface and reinforces the hole to prevent push-out

### Material

- Steel, zinc plated, clear trivalent passivated

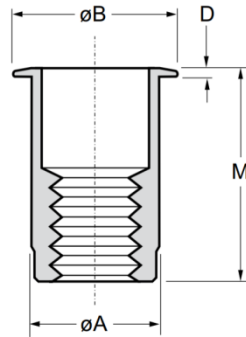

Before Placement

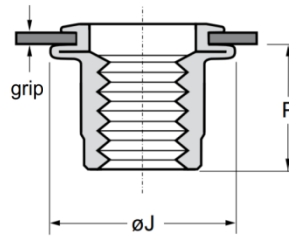

After Placement

Part No.	Thread Size	Grip Range		Hole Size	øA	øB	D	øJ	M	P
		min.	max.	+0.15/-0	max.	±0.25	±0.08	max.	±0.38	max.
DLS-470-2.0	M4 x 0.7 6H	0.5	2.0	6.80	6.75	9.91	0.76	9.91	10.67	7.75
DLS-470-3.3		2.0	3.3						11.94	
DLS-580-3.3	M5 x 0.8 6H	0.5	3.3	7.60	7.55	10.54		11.43	12.07	8.00
DLS-580-5.7		3.3	5.7						14.86	
DLS-610-4.2	M6 x 1.0 6H	0.7	4.2	10.00	9.90	12.70	0.89	13.97	14.73	9.65
DLS-610-6.6		4.2	6.6						17.27	
DLS-8125-3.8	M8 x 1.25 6H	0.7	3.8	13.50	13.45	17.40		13.97	17.53	11.94
DLS-8125-7.9		3.8	7.9						20.45	
DLS-1015-3.8	M10 x 1.5 6H	0.7	3.8	13.50	13.45	17.40	13.97	17.53	11.94	
DLS-1015-7.9		3.8	7.9					20.45		10.80

Thread Size	Max. torque	Pull-out	Torque-to-turn	Push-out
	Nm	kN	Nm	kN
M4 x 0.7 6H	6.2	2.3	1.1	0.8
M5 x 0.8 6H	10.7	2.8	1.4	1.5
M6 x 1.0 6H	18.1	3.0	1.4	1.4
M8 x 1.25 6H	N/A	5.0	2.7	2.3
M10 x 1.5 6H	N/A	5.0	2.7	2.3